



Monday

April 22, 2024

12:00-7:00 Exhibit Hall Setup – Magnolia Ballroom D E F
 2:00-7:00 Registration – Magnolia Foyer

**Tuesday
 April 23**

7:00-5:00 Registration– Magnolia Foyer
 7:00-5:00 Exhibits Open– Magnolia Ballroom D E F
7:00-8:30 Breakfast (Provided with Registration) – Magnolia Ballroom D E F

8:30-10:30 General Session – Magnolia Ballroom A B C
 Executive Director/Chair Welcome
 Local Welcome –
Keynote Speaker

10:30-11:00 BREAK / First Time Orientation – Magnolia Ballroom D E F

11:00-11:30 State Updates – FDEM State NFIP Coordinator/State Floodplain Manager, Bureau of Mitigation

11:30-12:00 Federal Updates – FEMA Region IV

12:00-1:00 LUNCH (Provided with Registration) - Magnolia Ballroom D E F

1:00-2:00 **Featured Speaker** – Magnolia Ballroom A B C

2:00-2:30 BREAK - Magnolia Ballroom D E F

2:30-4:30 **Presentations** - Magnolia Ballroom A B C

3:00-4:30 ISO One-on-Ones (See ISO staff for appointments) – Cypress Boardroom

5:00 - 7:00 Members Social/Karaoke – TBD

Wednesday

April 24

7:00-5:00 Registration– Magnolia Foyer
7:00-5:00 Exhibits Open – Magnolia Ballroom D E F
7:00-8:30 Breakfast (Provided with Registration) – Magnolia Ballroom D E F
8:00-5:00 ISO One-on-ones (See ISO staff for appointments) - Cypress Boardroom

8:30-10:00 **FFMA Project Updates by Region**

Region 1 – Azalea 1
Region 2 – Azalea 2
Region 3 – Azalea 3
Region 4 – Camellia 1
Region 5 – Camellia 2

10:00-10:30 BREAK– Magnolia Ballroom D E F

10:30-12:00 *Breakout Sessions (Details on next page)*

Floodplain Management Track	Azalea 1
Insurance	Azalea 2
CRS	Azalea 3
Resiliency	Camellia 1
Regulatory - Floodplain Mapping	Camellia 2

12:00-1:00 LUNCH (Provided with Registration) – Magnolia Ballroom D E F

1:00-2:30 *Breakout Sessions (Details on next page)*

Floodplain Management Track	Azalea 1
Insurance	Azalea 2
CRS	Azalea 3
Resiliency	Camellia 1
Regulatory - Floodplain Mapping	Camellia 2

2:30-3:00 BREAK – Magnolia Ballroom D E F

3:00-4:30 *Breakout Sessions (Details on next page)*

Floodplain Management Track	Azalea 1
Insurance	Azalea 2
CRS	Azalea 3
Resiliency	Camellia 1
Regulatory - Floodplain Mapping	Camellia 2

Wednesday April 24

10:30AM-12:00PM

Breakout sessions

Track	Session name	Presenter(s)	Room
Floodplain Management			Azalea 1
Insurance			Azelea 2
CRS			Azalea 3
Resiliency			Camellia 1
Regulatory – Floodplain Mapping			Camellia 2

1:00PM-2:30PM

Breakout sessions

Track	Session name	Presenter(s)	Room
Floodplain Management			Azalea 1
Insurance			Azelea 2
CRS			Azalea 3
Resiliency			Camellia 1
Regulatory – Floodplain Mapping			Camellia 2

3:00PM-4:30PM

Breakout sessions

Track	Session name	Presenter(s)	Room
Floodplain Management			Azalea 1
Insurance			Azelea 2
CRS			Azalea 3
Resiliency			Camellia 1
Regulatory – Floodplain Mapping			Camellia 2

Thursday April 25

- 7:00-5:00 Registration– Magnolia Foyer
- 7:00-4:30 Exhibits Open - Magnolia Ballroom D E F
- 7:00-8:30 Breakfast (Provided with Registration) – Magnolia Ballroom D E F**
- 8:00 - 12:00 ISO One-on-Ones (See ISO staff for appointments) – Cypress Boardroom
- 8:00-9:30 *Breakout Sessions (Details on next page)*
- | | |
|---------------------------------|------------|
| Floodplain Management Track | Azalea 1 |
| Insurance | Azalea 2 |
| CRS | Azalea 3 |
| Resiliency | Camellia 1 |
| Regulatory - Floodplain Mapping | Camellia 2 |
- 9:30-10:00 BREAK - Magnolia Ballroom D E F
- 10:00-11:30 *Breakout Sessions (Details on next page)*
- | | |
|---------------------------------|------------|
| Floodplain Management Track | Azalea 1 |
| Insurance | Azalea 2 |
| CRS | Azalea 3 |
| Resiliency | Camellia 1 |
| Regulatory - Floodplain Mapping | Camellia 2 |
- 11:30-12:30 LUNCH (Provided with Registration) – Magnolia Ballroom D E F**
- 12:30-2:00 *Breakout Sessions (Details on next page)*
- | | |
|---------------------------------|------------|
| Floodplain Management Track | Azalea 1 |
| Insurance | Azalea 2 |
| CRS | Azalea 3 |
| Resiliency | Camellia 1 |
| Regulatory - Floodplain Mapping | Camellia 2 |
- 2:00-2:30 BREAK – Magnolia Ballroom D E F - Exhibits Close
- 2:30-4:00 Annual Meeting/Closing Session – **Magnolia Ballroom A B C**
- 2:30-2:45 FFMA Board Elections
- 2:45-3:00 Executive Director Closing
- 3:00-4:00 **Featured Speaker**
- 4:15-5:00 RAFFLE – Coquina Ballroom D & E**

8:00AM-9:30AM

Breakout sessions

Track	Session name	Presenter(s)	Room
Floodplain Managemen			Azalea 1
Insurance			Azelea 2
CRS			Azalea 3
Resiliency			Camellia 1
Regulatory – Floodplain Mapping			Camellia 2

10:00AM-11:30AM

Breakout sessions

Track	Session name	Presenter(s)	Room
Floodplain Managemen			Azalea 1
Insurance			Azelea 2
CRS			Azalea 3
Resiliency			Camellia 1
Regulatory – Floodplain Mapping			Camellia 2

12:30PM-2:00PM

Breakout sessions

Track	Session name	Presenter(s)	Room
Floodplain Managemen			Azalea 1
Insurance			Azelea 2
CRS			Azalea 3
Resiliency			Camellia 1
Regulatory – Floodplain Mapping			Camellia 2

Friday

April 26

7:00-10:00

Registration- Magnolia Foyer

7:00-8:30

Breakfast (Provided with Registration) - Magnolia Foyer

8:00 - 12:00

ISO One-on-Ones (See ISO staff for appointments) – Cypress Boardroom

All Tours Meet at FFMA Registration Desk in the Magnolia Foyer

8:00 - 12:00

Tour 1 –

8:00 - 12:00

Tour 2 –

8:30-10:00

Breakout Sessions

10:00-10:30

BREAK- Magnolia Foyer

10:30-12:00

Breakout Sessions

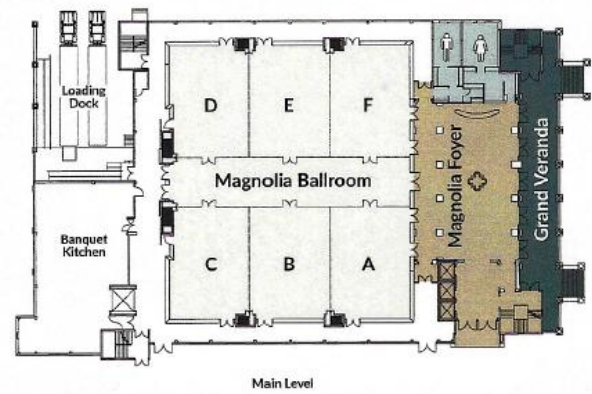
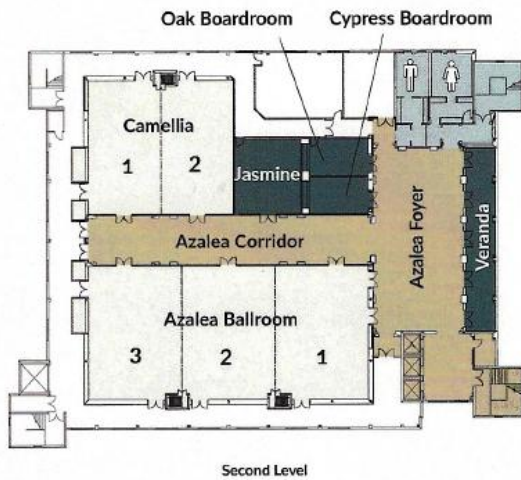

10/16/2023 – 1st Draft