



Monday

April 22, 2024

12:00-7:00 Exhibit Hall Setup – Magnolia Ballroom D E F
 2:00-7:00 Registration – Magnolia Foyer

Tuesday

April 23

7:00-5:00 Registration– Magnolia Foyer
 7:00-5:00 Exhibits Open– Magnolia Ballroom D E F
7:00-8:30 Breakfast (Provided with Registration) – Magnolia Ballroom D E F

8:30-10:30 General Session – Magnolia Ballroom A B C
 Executive Director/Chair Welcome
 Local Welcome – Walton County Commissioner Tony Anderson
Keynote Speaker – Senator Jay Trumbell

10:30-11:00 BREAK / First Time Orientation – Magnolia Ballroom D E F

11:00-11:30 **State Updates** – FDEM State NFIP Coordinator/State Floodplain Manager, Bureau of Mitigation

11:30-12:00 **Federal Updates – FEMA Region IV** - Jason Hunter

12:00-1:00 LUNCH (Provided with Registration) - Magnolia Ballroom D E F

1:00-2:30 **Featured Speaker –Inside Florida’s Pre and Post Disaster Operations: Lessons learned after Hurricane Ian, Nicole, and Adalia** - Conn Cole & Michael Burchette - Magnolia Ballroom A B C

2:30-3:00 BREAK - Magnolia Ballroom D E F

3:00-4:30 **Panel Discussion - Funding Opportunities from the State of Florida**– Eddy Bouza (FDEP) - Magnolia Ballroom A B C

3:00-4:30 ISO One-on-Ones (See ISO staff for appointments) – Cypress Boardroom
 3:00-5:00 FDEM Office Hours (Contact floods@em.myflorida.com for appointments) – Oak Boardroom

5:30 - 9:00 Members Social/Karaoke/DJ – Magnolia Ballrooms

Wednesday

April 24

7:00-5:00 Registration– Magnolia Foyer
7:00-5:00 Exhibits Open – Magnolia Ballroom D E F
7:00-8:30 Breakfast (Provided with Registration) – Magnolia Ballroom D E F
8:00-5:00 ISO One-on-ones (See ISO staff for appointments) - Cypress Boardroom
9:00-4:30 FDEM Office Hours (Contact floods@em.myflorida.com for appointments) – Oak Boardroom

8:30 Tour – (duration 9am – 5pm) Mexico Beach – 5 Years After – A Personal Story – Del Schwalls - Meet at FFMA Registration Desk in the Magnolia Foyer

8:30-10:00 FFMA Project Updates by Region

Region 1 – Azalea 1
Region 2 – Azalea 2
Region 3 – Azalea 3
Region 4 – Camellia 1
Region 5 – Camellia 2

10:00-10:30 BREAK – Magnolia Ballroom D E F

10:30-12:00 Breakout Sessions (Details on next page)

Floodplain Management Track	Azalea 1
Insurance	Azalea 2
CRS	Azalea 3
Resiliency	Camellia 1
Floodplain Training	Camellia 2

12:00-1:00 LUNCH (Provided with Registration) – Magnolia Ballroom D E F

1:00-2:30 Breakout Sessions (Details on next page)

Floodplain Management Track	Azalea 1
Insurance	Azalea 2
CRS	Azalea 3
Resiliency	Camellia 1
Floodplain Training	Camellia 2

2:30-3:00 BREAK – Magnolia Ballroom D E F

3:00-4:30 Breakout Sessions (Details on next page)

Floodplain Management Track	Azalea 1
Insurance	Azalea 2
CRS	Azalea 3
Resiliency	Camellia 1
Floodplain Training	Camellia 2

Wednesday April 24

10:30AM-12:00PM

Breakout sessions

Track	Session name	Presenter(s)	Room
Floodplain Management	How to potentially add 8,000 homes to a New Flood Zone and Live to Tell the Tale (30)	Brad Heilwagen & Leroy Marshall	Azalea 1
	Data Driven Resident Flood Communication & Outreach (30)	Michelle Leong	
	Introducing the CNNS Unmapped Inventory Baseline and Tracking FEMA Region 4 Status (30)	Benjamin Young & Susan Morris	
Insurance	Insurance 101 for CFM's and CRS Coordinators (45)	Denise Boehning	Azelea 2
CRS	Successfully Navigating the Twin Peaks of CRS and Resiliency Planning (45)	Erin Deady & Lori Lehr	Azalea 3
	The Road to CRS Class 2 (45)	Maxine Moore	
Resiliency	Lessons Learned: Flood Mitigation Action Planning in Pinellas County (45)	Lauren Wolf & Nicholas Troilo	Camellia 1
	The FDEP's Approach to Flood Hazard Analysis for a Statewide Vulnerability Assessment (45)	Michael DelCharco & Eddy Bouza	
Floodplain Training	Flood Provisions of the FBC 2023 (8th Edition) (90)	John Travers & Vince Seijas	Camellia 2

1:00PM-2:30PM Breakout sessions

Track	Session name	Presenter(s)	Room
Floodplain Management	Flood Forecast Modeling for Improved Flood Warning And Response (45)	Mathew Deal & Lisa Foster	Azalea 1
Insurance			Azalea 2
CRS	Repetitive Loss in Floodplain Management: Insights and Mitigation Strategies (30)	Conn Cole & Liz Russell	Azalea 3
	Community Rating System (CRS) Class Prerequisites (45)	Amanda Gowans	
Resiliency	A Comprehensive Watershed Management Plan Aimed at the Rehabilitation of a Culturally Significant Urban Creek and Bayou in the Heart of Pensacola, FL (30)	Jeanette Kelson & Crissy Mehle	Camellia 1
	Improving Statewide Resilience in Florida: Resilient Florida program (30)	Krista Shipley	
Floodplain Training	NFIP Regulations (90)	Mike Rimoldi	Camellia 2

3:00PM-4:30PM Breakout sessions

Track	Session name	Presenter(s)	Room
Floodplain Management	National Violation Tracker – Updates (30)	Tammy Hansen	Azalea 1
	Update on FEMA’s Substantial Damage Administrative Procedures Workshops (30)	James Mascellino	
	FEMA Region 4 Environmental Planning and Historic Preservation Overview (30)	Cary Helmuth	
Insurance			Azelea 2
CRS	CRS Credit for Substantial Damage Management Plans (45)	Amanda Gowans	Azalea 3
Resiliency	Modeling Compound Flooding in Real-Time (45)	Pete Singhofen & Warren McKinnie	Camellia 1
Floodplain Training	NFIP Regulations (90)	Mike Rimoldi	Camellia 2

Thursday April 25

7:00-5:00 Registration– Magnolia Foyer
7:00-2:30 Exhibits Open - Magnolia Ballroom D E F
7:00-8:30 Breakfast (Provided with Registration) – Magnolia Ballroom D E F
8:00 - 12:00 ISO One-on-Ones (See ISO staff for appointments) – Cypress Boardroom
9:00 – 12:00 FDEM Office Hours (Contact floods@em.myflorida.com for appointments) – Oak Boardroom

8:00-9:30 *Breakout Sessions (Details on next page)*
Floodplain Management Track Azalea 1
Insurance Azalea 2
CRS Azalea 3
Resiliency Camellia 1
Floodplain Training Camellia 2

9:30-10:00 BREAK - Magnolia Ballroom D E F

10:00-11:30 *Breakout Sessions (Details on next page)*
Floodplain Management Track Azalea 1
Insurance Azalea 2
CRS Azalea 3
Resiliency Camellia 1
Floodplain Training Camellia 2

11:30-12:30 LUNCH (Provided with Registration) – Magnolia Ballroom D E F

12:30-2:00 *Breakout Sessions (Details on next page)*
Floodplain Management Track Azalea 1
Insurance Azalea 2
CRS Azalea 3
Resiliency Camellia 1
Floodplain Training Camellia 2

2:00-2:30 BREAK – Magnolia Ballroom D E F - Exhibits Close

2:30-4:00 Annual Meeting/Closing Session – **Magnolia Ballroom A B C**
2:30-2:45 FFMA Board Elections
2:45-3:00 Executive Director Closing
3:00-4:00 **Featured Speaker** – Program Makeover- CRS Edition (CRS Redesign Engagement with Floodplain Managers) FEMA - Federal Insurance Directorate– Tony Hake

4:15-5:00 RAFFLE – Magnolia Ballroom A B C

Thursday April 25th

8:00AM-9:30AM

Breakout sessions

Track	Session name	Presenter(s)	Room
Floodplain Management	Assessing Uncertainty in Precipitation Extremes and its Impact on Spatial Inundation Extents, Coupled with Structural Stormwater Management Alternatives (30)	Anika Azad	Azalea 1
	Integration of Emergency Management with the CFM Role in a Disaster Event (30)	Christopher Mason & William Lang	
Insurance	Arkly.com:Flood Risk Management for Florida Homeowners (30)	Adrian Santiago Tate	Azelea 2
CRS	Harnessing the Power of a PPI (45)	Mechelle Olivier	Azalea 3
	Community Rating System (CRS) Annual Requirements (45)	Amanda Gowans	
Resiliency	Navigating Flood Vulnerabilities and Enhancing Resilience in Panama City, Florida (45)	Sean Lahav & Jennifer Aldridge	Camellia 1
	Advancing Nature-Based Solutions at the Federal and Local Government Scales (45)	Hank Hodde	
Floodplain Training	FEMA Mapping (90)	Stephen Boehning	Camellia 2

10:00AM-11:30AM

Breakout sessions

Track	Session name	Presenter(s)	Room
Floodplain Management	Innovative Technology for Proactive Flood Management (30)	Derek Slocum & Lindsey Corbett	Azalea 1
	Cite Your Sources: How to Handle Multiple Sources Of Flood Risk (30)	Mark Pauls & Robert Wood	
Insurance	FEMA Hurricane Ian MAT NFIP Claims Analysis (45)	Dan Bass	Azelea 2
CRS	Elevation Certificate Missteps: Connecting Guidance to the Real World (90)	Del Schwalls	Azalea 3
Resiliency	Funding Nature-Based Solutions - Enhancing Wetlands for Floodplain Storage in Panama City (30)	Jason Ressler & Jennifer Aldridge	Camellia 1
	Nature-Based Solutions (NbS) for Flood Mitigation in Florida and Connecting NbS with Local/Federal Funding (45)	Kulvir Singh & Mary Diaz	
Floodplain Training	FEMA Mapping (90)	Stephen Boehning	Camellia 2

1:00PM-2:30PM

Breakout sessions

Track	Session name	Presenter(s)	Room
Floodplain Management	Repairs, Alterations, and Elevations -What is REALLY Required from the Florida Building Code? (45)	Mike Rimoldi & Erik Fritzberg	Azalea 1
CRS	How to Navigate your First Verification Cycle Visit (90)	Denise Boehning	Azalea 3
Resiliency	The Value Proposition for Temporary, Surface-Applied, Removable, Flood Protection Products as a means to reduce property loss in emergencies (30)	Sam Bays	Camellia 1
Floodplain Training	FEMA Mapping (90)	Steve Boehning	Camellia 2

**Friday
April 26**

7:00-10:00 Registration- Magnolia Foyer
7:00-8:30 Breakfast (Provided with Registration) - Magnolia Foyer
 8:00 - 12:00 ISO One-on-Ones (See ISO staff for appointments) – Cypress Boardroom

All Tours Meet at FFMA Registration Desk in the Magnolia Foyer

8:00 - 12:00 Tour 1 – Topsail Hill Preserve State Park Tour
 8:30 - 12:00 Tour 2 – Deer Lake State Park Wetland Restoration Tour

8:30-10:00 *Breakout Sessions*

			Camellia 1
Floodplain Training	Elevation Certificate (90)	Karen Thornhill	Camellia 2

10:00-10:30 BREAK- Magnolia Foyer

10:30-12:00 *Breakout Sessions*

			Camellia 1
Floodplain Training	Elevation Certificate (90)	Karen Thornhill	Camellia 2

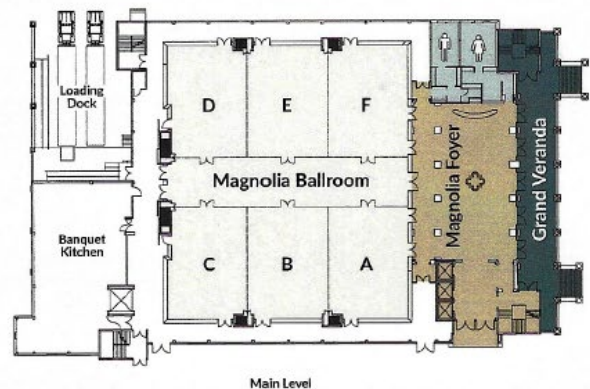
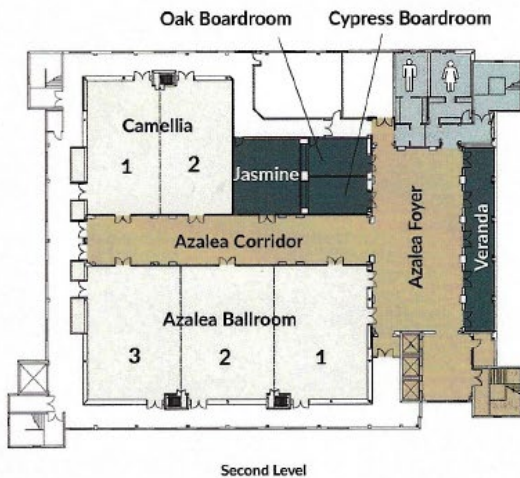

10/16/2023 – 1st Draft
 1/5/2024 – Update
 2/2/24 – Update
 2/7/24 – Update
 2/9/29 – Update
 2/13/24 – Update
 2/15/24 – Update
 2/22/2024 – Update
 2/29/2024 – Update
 3/6/2024 – Update
 3/7/2024 - Update
 3/12/2024 – Update
 3/20/2024 - Update