



## Monday

**April 22, 2024**

- 12:00-7:00 Exhibit Hall Setup – Magnolia Ballroom D E F  
 2:00-7:00 Registration – Magnolia Foyer

## Tuesday April 23

- 7:00-5:00 Registration– Magnolia Foyer  
 7:00-5:00 Exhibits Open– Magnolia Ballroom D E F  
**7:00-8:30 Breakfast (Provided with Registration) – Magnolia Ballroom D E F**
- 8:30-10:30 General Session – Magnolia Ballroom A B C  
 Executive Director/Chair Welcome  
 Local Welcome – Bay County Commissioner Robert Carroll  
**Keynote Speaker – Senator Jay Trumbell**
- 10:30-11:00 BREAK / First Time Orientation – Magnolia Ballroom D E F
- 11:00-11:30 **State Updates – FDEM State NFIP Coordinator/State Floodplain Manager, Bureau of Mitigation**
- 11:30-12:00 **Federal Updates – FEMA Region IV - Jason Hunter**
- 12:00-1:00 LUNCH (Provided with Registration) - Magnolia Ballroom D E F**
- 1:00-2:30 **Featured Speaker –Inside Florida’s Pre and Post Disaster Operations: Lessons learned after Hurricane Ian, Nicole, and Adalia – FDEM Staff - Magnolia Ballroom A B C**
- 2:30-3:00 BREAK - Magnolia Ballroom D E F
- 3:00-4:30 **Show Me the Money! Panel Discussion - Funding Opportunities from the State of Florida– Eddy Bouza (FDEP) & Laura Dhuwe (FDEM) - Magnolia Ballroom A B C**
- 3:00-4:30 ISO One-on-Ones (See ISO staff for appointments) – Cypress Boardroom  
 3:00-5:00 FDEM Office Hours (Contact [floods@em.myflorida.com](mailto:floods@em.myflorida.com) for appointments) – Oak Boardroom
- 5:30 - 9:00 Members Social/Karaoke/DJ – Magnolia Ballrooms

## Wednesday

### April 24

7:00-5:00 Registration– Magnolia Foyer  
7:00-5:00 Exhibits Open – Magnolia Ballroom D E F  
**7:00-8:30 Breakfast (Provided with Registration) – Magnolia Ballroom D E F**  
8:00-5:00 ISO One-on-ones (See ISO staff for appointments) - Cypress Boardroom  
9:00-12:00 FDEM Office Hours (Contact [floods@em.myflorida.com](mailto:floods@em.myflorida.com) for appointments) – Oak Boardroom

**8:30 Tour – (duration 9am – 5pm) Mexico Beach – 5 Years After – A Personal Story – Del Schwalls - Meet at FFMA Registration Desk in the Magnolia Foyer**

**8:30-10:00 FFMA Project Updates by Region**

Region 1 – Azalea 1  
Region 2 – Azalea 2  
Region 3 – Azalea 3  
Region 4 – Camellia 1  
Region 5 – Camellia 2

**10:00-10:30 BREAK – Magnolia Ballroom D E F**

*10:30-12:00 Breakout Sessions (Details on next page)*

Floodplain Management Track	Azalea 1
Insurance	Azalea 2
CRS	Azalea 3
Resiliency	Camellia 1
Floodplain Training	Camellia 2

**12:00-1:00 LUNCH (Provided with Registration) – Magnolia Ballroom D E F**

1:30-4:30 FDEM Office Hours (Contact [floods@em.myflorida.com](mailto:floods@em.myflorida.com) for appointments) – Oak Boardroom

*1:00-2:30 Breakout Sessions (Details on next page)*

Floodplain Management Track	Azalea 1
CRS	Azalea 3
Resiliency	Camellia 1
Floodplain Training	Camellia 2

**2:30-3:00 BREAK – Magnolia Ballroom D E F**

*3:00-4:30 Breakout Sessions (Details on next page)*

Floodplain Management Track	Azalea 1
CRS	Azalea 3
Resiliency	Camellia 1
Floodplain Training	Camellia 2

**Wednesday April 24**

10:30AM-12:00PM

Breakout sessions

Track	Session name	Presenter(s)	Room
Floodplain Management	How to potentially add 8,000 homes to a New Flood Zone and Live to Tell the Tale	Brad Heilwagen & Leroy Marshall	Azalea 1
	Data Driven Resident Flood Communication & Outreach	Susanna Pho	
	Introducing the CNNS Unmapped Inventory Baseline and Tracking FEMA Region 4 Status	Benjamin Young & Susan Morris	
Insurance	Insurance 101 for CFM's and CRS Coordinators	Denise Boehning	Azelea 2
CRS	Successfully Navigating the Twin Peaks of CRS and Resiliency Planning	Erin Deady & Lori Lehr	Azalea 3
	The Road to CRS Class 2	Maxine Moore	
Resiliency	Lessons Learned: Flood Mitigation Action Planning in Pinellas County	Kent Boulicault & Nicholas Troilo	Camellia 1
	The FDEP's Approach to Flood Hazard Analysis for a Statewide Vulnerability Assessment	Michael DelCharco & Eddy Bouza	
Floodplain Training	FEMA Mapping	Stephen Boehning	Camellia 2

1:00PM-2:30PM Breakout sessions

Track	Session name	Presenter(s)	Room
Floodplain Management	Assessing Uncertainty in Precipitation Extremes and its Impact on Spatial Inundation Extents, Coupled with Structural Stormwater Management Alternatives	Anika Azad	Azalea 1
	Ordinance Roundtable	Kelli DeFedericis & Ayita Lonergan	
CRS	Repetitive Loss in Floodplain Management: Insights and Mitigation Strategies	Conn Cole & Liz Russell	Azalea 3
	Community Rating System (CRS) Class Prerequisites	Amanda Gowans	
Resiliency	A Comprehensive Watershed Management Plan Aimed at the Rehabilitation of a Culturally Significant Urban Creek and Bayou in the Heart of Pensacola, FL	Jeanette Kelson & Crissy Mehle	Camellia 1
	Improving Statewide Resilience in Florida: Resilient Florida program	Krista Shipley	
Floodplain Training	NFIP Regulations	Mike Rimoldi	Camellia 2

3:00PM-4:30PM Breakout sessions

Track	Session name	Presenter(s)	Room
Floodplain Management	National Violation Tracker – Updates	Tammy Hansen	Azalea 1
	Update on FEMA's Substantial Damage Administrative Procedures Workshops	James Mascellino	
	FEMA Region 4 Environmental Planning and Historic Preservation Overview	Cary Helmuth	
CRS	CRS Credit for Substantial Damage Management Plans	Amanda Gowans	Azalea 3
	A Guide to Achieving CRS Class 4	Lori Lehr	
Resiliency	Modeling Compound Flooding in Real-Time	Pete Singhofen & Warren McKinnie	Camellia 1
Floodplain Training	NFIP Regulations	Mike Rimoldi	Camellia 2

## Thursday April 25

7:00-5:00 Registration– Magnolia Foyer  
7:00-2:30 Exhibits Open - Magnolia Ballroom D E F  
**7:00-8:30 Breakfast (Provided with Registration) – Magnolia Ballroom D E F**  
8:00 - 12:00 ISO One-on-Ones (See ISO staff for appointments) – Cypress Boardroom  
9:00 – 12:00 FDEM Office Hours (Contact [floods@em.myflorida.com](mailto:floods@em.myflorida.com) for appointments) – Oak Boardroom

8:00-9:30 *Breakout Sessions (Details on next page)*  
Floodplain Management Track Azalea 1  
Insurance Azalea 2  
CRS Azalea 3  
Resiliency Camellia 1  
Floodplain Training Camellia 2

9:30-10:00 BREAK - Magnolia Ballroom D E F

10:00-11:30 *Breakout Sessions (Details on next page)*  
Floodplain Management Track Azalea 1  
Insurance Azalea 2  
CRS Azalea 3  
Resiliency Camellia 1  
Floodplain Training Camellia 2

**11:30-12:30 LUNCH (Provided with Registration) – Magnolia Ballroom D E F**  
**(Florida Wildlife Corridor film – Del Schwalls)**

12:30-2:00 *Breakout Sessions (Details on next page)*  
Floodplain Management Track Azalea 1  
CRS Azalea 3  
Resiliency Camellia 1  
Floodplain Training Camellia 2

2:00-2:30 BREAK – Magnolia Ballroom D E F - Exhibits Close

2:30-4:00 Annual Meeting/Closing Session – **Magnolia Ballroom A B C**  
2:30-3:15 **Featured Speaker** – Program Makeover- CRS Edition (CRS Redesign Engagement with Floodplain Managers) FEMA - Federal Insurance Directorate– Tony Hake  
3:15-3:45 Sponsor Spotlight  
3:45 – 4:00 FFMA Board Elections  
4:00 – 4:15 Executive Director Closing

**4:15-5:00 RAFFLE – Magnolia Ballroom A B C**

**5:00-6:00 Meet the New Director of Operations – Magnolia Ballroom A B C – Tentative**  
**Light Appetizers/Cash Bar**

**Thursday April 25th**

8:00AM-9:30AM

Breakout sessions

Track	Session name	Presenter(s)	Room
Floodplain Management	Integration of Emergency Management with the CFM Role in a Disaster Event	Christopher Mason & William Lang	Azalea 1
	Flood Forecast Modeling for Improved Flood Warning and Response	Mathew Deal & Lisa Foster	
Insurance	Arkly.com:Flood Risk Management for Florida Homeowners	Adrian Santiago Tate	Azelea 2
	Opening the Black Box of Risk Rating 2.0: Challenges and Solutions for Floodplain Management	Brad Hubbard & Robert Stefanic	
CRS	Harnessing the Power of a PPI	Mechelle Olivier	Azalea 3
	Community Rating System (CRS) Annual Requirements	Amanda Gowans	
Resiliency	Navigating Flood Vulnerabilities and Enhancing Resilience in Panama City, Florida	Sean Lahav & Jennifer Aldridge	Camellia 1
	Advancing Nature-Based Solutions at the Federal and Local Government Scales	Jason Bird	
Floodplain Training	Flood Provisions of the FBC 2023 (8th Edition)	John Travers & Vince Seijas	Camellia 2

10:00AM-11:30AM

Breakout sessions

Track	Session name	Presenter(s)	Room
Floodplain Management	Cite Your Sources: How to Handle Multiple Sources Of Flood Risk	Mark Pauls & Robert Wood	Azelea 1
	FIS Report – How to Use the Manual	Elizabeth Fountain	
Insurance	FEMA Hurricane Ian MAT NFIP Claims Analysis	John “Bud” Plisch & Manny Perotin	Azelea 2
	Risk Rating 2.0 Workgroup and National Violation Tracker Update	Lisa Foster	
CRS	Elevation Certificate Missteps: Connecting Guidance to the Real World	Del Schwalls	Azalea 3
Resiliency	Funding Nature-Based Solutions - Enhancing Wetlands for Floodplain Storage in Panama City	Jason Ressler & Jennifer Aldridge	Camellia 1
	Nature-Based Solutions (NbS) for Flood Mitigation in Florida and Connecting NbS with Local/Federal Funding	Kulvir Singh & Mary Diaz	
Floodplain Training	FEMA Mapping	Stephen Boehning	Camellia 2

12:30PM-2:00PM

Breakout sessions

Track	Session name	Presenter(s)	Room
Floodplain Management	Repairs, Alterations, and Elevations -What is REALLY Required from the Florida Building Code?	Mike Rimoldi & Erik Fritzberg	Azalea 1
CRS	How to Navigate your First Verification Cycle Visit	Denise Boehning	Azalea 3
Resiliency	The Value Proposition for Temporary, Surface-Applied, Removable, Flood Protection Products as a means to reduce property loss in emergencies	Sam Bays	Camellia 1
	Post Disaster Permitting: My experience as a County Ombudsman	John Stockham	
Floodplain Training	FEMA Mapping	Steve Boehning	Camellia 2

**Friday**

**April 26**

- 7:00-10:00 Registration- Magnolia Foyer
- 7:00-8:30 **Breakfast (Provided with Registration)** - Magnolia Foyer
- 8:00 - 12:00 ISO One-on-Ones (See ISO staff for appointments) – Cypress Boardroom

**All Tours Meet at FFMA Registration Desk in the Magnolia Foyer**

- 8:00 - 12:00 Tour 1 – Topsail Hill Preserve State Park Tour
- 8:30 - 12:00 Tour 2 – Deer Lake State Park Wetland Restoration Tour

8:30-10:00 *Breakout Sessions*

Floodplain Training	Elevation Certificate	Karen Thornhill	Camellia 1 & 2
---------------------	-----------------------	-----------------	----------------

10:00-10:30 BREAK- Magnolia Foyer

10:30-12:00 *Breakout Sessions*

Floodplain Training	Elevation Certificate	Karen Thornhill	Camellia 1 & 2
---------------------	-----------------------	-----------------	----------------

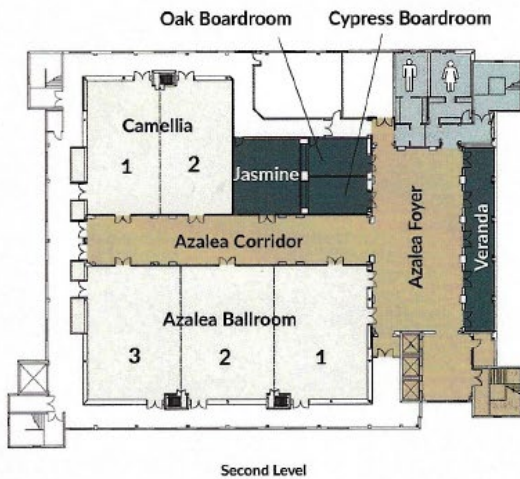

- 10/16/2023 – 1<sup>st</sup> Draft
- 1/5/2024 – Update
- 2/2/24 – Update
- 2/7/24 – Update
- 2/9/29 – Update
- 2/13/24 – Update
- 2/15/24 – Update
- 2/22/2024 – Update
- 2/29/2024 – Update
- 3/6/2024 – Update
- 3/7/2024 - Update
- 3/12/2024 – Update
- 3/20/2024 – Update

- 4/15/2024 - Update
- 4/16/2024 - Update
- 4/17/2024 - Update

4/10/2024 – Update

4/11/2024 – Update

4/12/2024 - Update